

# The Basic Series Metal Access Door



Date: \_\_\_\_\_

Distributor: \_\_\_\_\_

Project: \_\_\_\_\_

Approval By: \_\_\_\_\_

Specification Reference: \_\_\_\_\_

Contractor: \_\_\_\_\_

Architect: \_\_\_\_\_

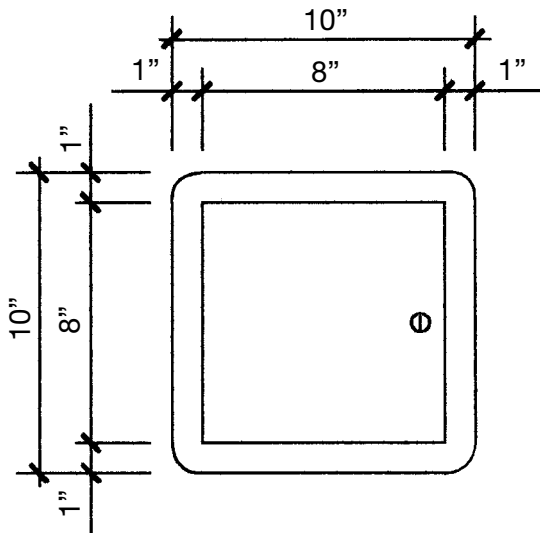

**ELEVATION**

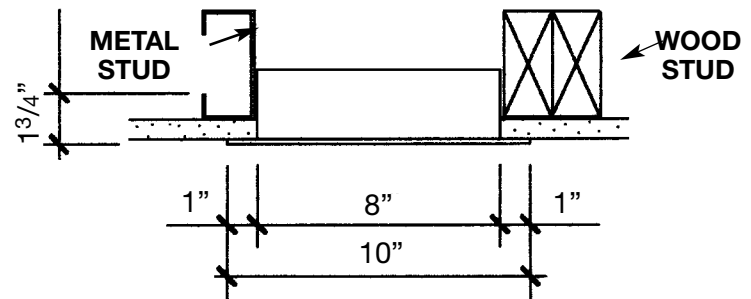

**SECTION DETAIL**

## SPECIFICATIONS

### MATERIALS:

Door Panel & Frame: 18 gauge steel  
(Up to and including 16" x 16")

Door Panel & Frame: 16 gauge steel  
(Up to and including 24" x 24")

### FINISH:

Satin coat galvanized ready for paint.

### HINGE:

Pin hinge top and bottom.

### LOCK:

Stainless steel flush screwdriver cam.

### PACKAGE:

Individually boxed.

### APPLICATION:

Wall & Ceiling.

NOTE: SPECIAL SIZES AND MODIFICATIONS NOT AVAILABLE.

Door Size	Wall Opening Opening	Cam Latches	Shipping Wt. Lbs.
8" x 8"	8 1/4" x 8 1/4"	1	3
10" x 10"	10 1/4" x 10 1/4"	1	4
12" x 12"	12 1/4" x 12 1/4"	1	5
14" x 14"	14 1/4" x 14 1/4"	3	6.25
16" x 16"	16 1/4" x 16 1/4"	3	7.33
18" x 18"	18 1/4" x 18 1/4"	3	11
22" x 22"	22 1/4" x 22 1/4"	4	15
24" x 24"	24 1/4" x 24 1/4"	4	17

Manufactured in Canada.